

Do not push the tamper button **before** installation

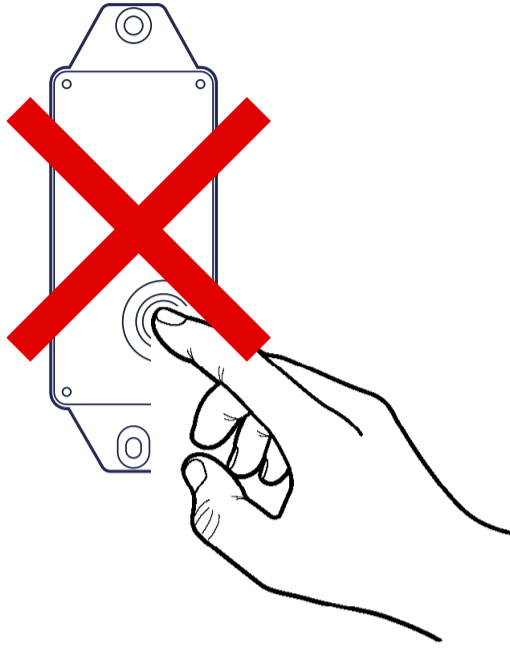

Do **not** open the tracker.

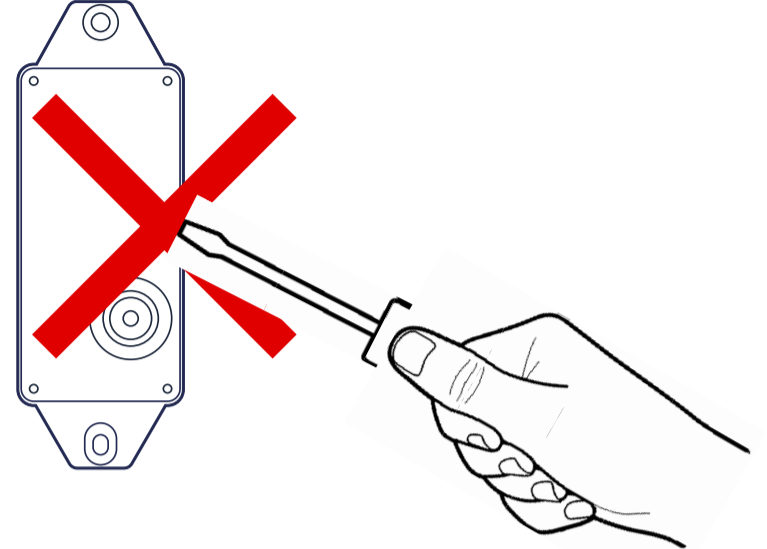

We recommend to install with rivets

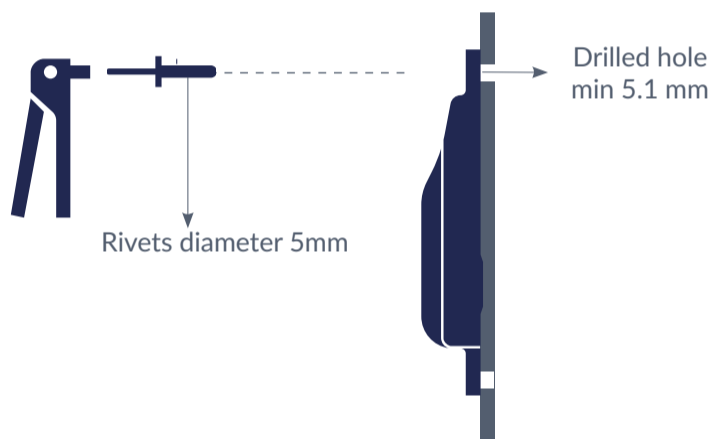

Rivets are advised as they are more secure and tamper proof.

The height of the casing where the mounting holes are located is 8mm.

We recommend Gesipa Blind Rivets Aluminium/Steel Standard Flat Head 5 x 16 mm.

Installation with bolts

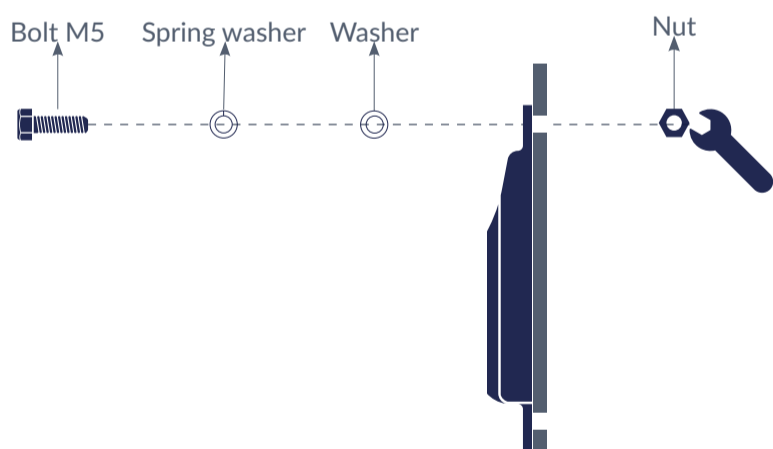

1. It is recommended to use M5 bolts and to use thread locking glue on the bolts. We recommend Loctite Thread Locker Blue 242.

2. Protect the casing with a washer and use a spring washer to mitigate the effects of vibration and temperature variations.

3. The maximum allowed torque is 1.25Nm for an M5 x 12 mm screw used with a washer. Applying more torque may severely damage the tracker's casing.

# Tracker installation and activation

## Step 1: Install the tracker

The activation is done **automatically** when the tracker is installed properly on an flat surface and the tamper button is pressed **continuously for 60 seconds**.

- Activation of the tracker is preferably done with clear skies, and not inside (e.g. factory or warehouse).
- Trackers are not activated when delivered to your premises.
- The subscription in the platform will start within six month of purchase.

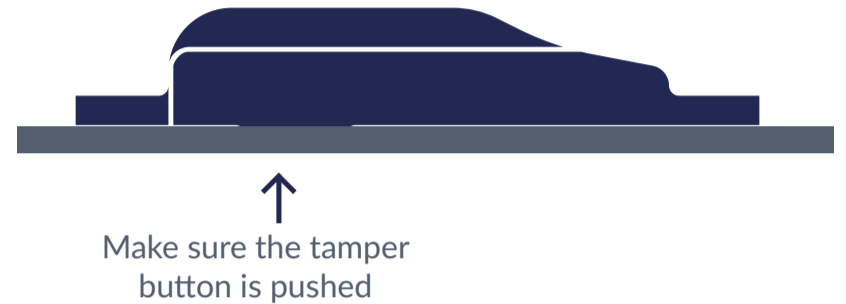
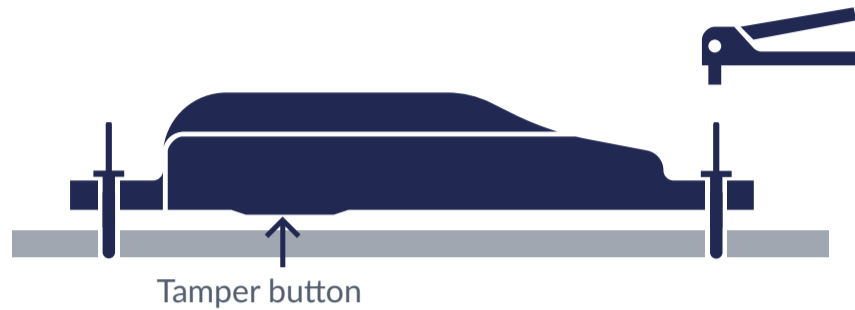

The recommended orientation is vertical (upright) with the arrows on the sticker pointing upwards.



The second best orientation is horizontal (sideways).

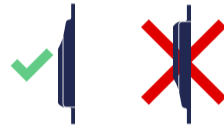

Do **not** mount the tracker upside down.



Avoid placing the tracker in a place that can collect water.



Do not mount on round surfaces, **this will impact the tamper functionality.**

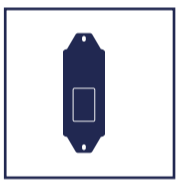

Avoid blocking the tracker's view with metal or carbonfibre walls. They weaken or block the radiofrequency signals.

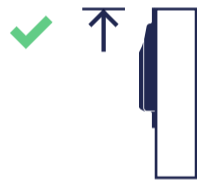

Place the tracker as high as possible on the asset to ensure good network coverage.



Make sure the mounting surface is **flat and clean**, for a strong and durable bond and to secure the tamper function will work.



Do not install the tracker on parts that receive frequent shocks or vibrations.

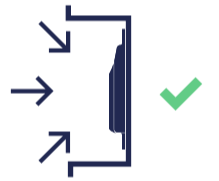

You can place the tracker in a protected location, but never with metal or carbonfibre above the tracker.



Make sure the tracker has a clear view on the sky..

## Step 2: Check in the platform

Check in the platform or the Sensolus app if the tracker is online. To find a tracker in the platform.

The trackers do not have a Sensolus serial on the device but the Sigfox device ID.

- You can find your trackers by entering the Sigfox ID in the global search. (Find the Sigfox ID on the side of the TRACK 1030).
- To see the asset Sigfox IDs in the asset list, click **Column settings > Select Sigfox device ID checkbox > Save.**



Sigfox device ID